



5/15241483/1212

Directions for use

Read carefully!

0.9% Sodium Chloride

Formulation

100 mL of solution contain

Active ingredients:

Sodium Chloride 0.9 g

Excipient:

Water for Injections

Theoretical osmolarity: 308 mOsm/L

Titration acidity: < 0.3 mmol/L

pH: 4.5 -7.0

Electrolyte concentrations:

Sodium 154 mmol/L

Chloride 154 mmol/L

Pharmaceutical form

Solution for injection

Pharmaco-therapeutic group

Vehicle solution.

Indications

Solvent for the preparation or dilution of parenterally administered drugs.

Contraindications

0.9% Sodium Chloride Injection should only be administered with particular caution to patients with

- hypernatraemia
- hyperchloraemia

Caution

Foods, Drugs, Devices & Cosmetics Act prohibits dispensing without prescription.

Precautions for use and special warnings

None

Interactions

When mixing with other medicaments, possible incompatibilities should be considered.

Dosage

The quantity to be chosen depends on the desired concentration of the medicament to be dissolved.

For the use of this solution as solvent/diluent for compatible electrolyte concentrates or medicaments, the instructions for use relating to the medicament to be added should be observed.

Method of administration

Intravenous or subcutaneous injection.

Overdose

Symptoms

Overdose of 0.9% Sodium Chloride solution may result in hypernatraemia, hyperchloraemia, hyperhydration, hyperosmolarity of the serum, and metabolic acidosis.

Emergency treatment, antidotes

Immediate stop of administration, administration of diuretics with continuous monitoring of serum electrolytes, correction of electrolyte and acid-base imbalances.

Undesirable effects

Administration of larger amounts of the solution may lead to hypernatraemia and hyperchloraemia

Note

Patients are advised to inform their doctor or pharmacist of any adverse reaction they experience in connection with the administration of this drug.

Usage during pregnancy

No adverse reaction has been reported. However, risk versus benefits should be assessed before using.

Storage

Store at temperatures not exceeding 30°C.



Schwarz
148x210 mm
5/15241483/1212
Lätus: 1497
Philippinen

B | BRAUN



5/15241483/1212

Shelf life

The product must not be used beyond the expirydate stated on the label.

Availability

In plastic ampoules "Mini-Plasco®" of 10 mL, 20 mL in box of 20's.

Instructions for use / handling

The solution is supplied in single-use containers.

Discard unused contents.

Use contents immediately after opening the container.

Only to be used if solution is clear and the container undamaged.

DR-XY13373

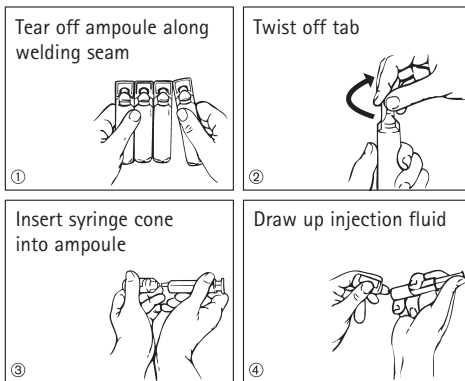

Manufactured by:
**B. Braun Medical
Industries Sdn. Bhd.**
11900 Bayan Lepas,
Penang, Malaysia.

Imported by:
**B. Braun Medical
Supplies, Inc.**
15th Floor Sun Life Centre
5th Ave. cor. Rizal Drive,
Bonifacio Global City,
Taguig City

B | BRAUN



Schwarz
148x210 mm
5/15241483/1212
Lätus: 1497
Philippinen